

Product information

Truma VarioHeat and E-Kit

July 2018



heating | cooling | controlling

 **truma**
More comfort on the move

Truma VarioHeat

The new compact Truma heaters for motor homes, caravans and vans.

Truma VarioHeat eco and Truma VarioHeat comfort are of an identical size, but have a different output. The compact design enables both variants to be installed flexibly in the vehicle without losing any storage space.

The Truma E-Kit supplements the Truma VarioHeat with an electric heater. Both appliances are controlled via the Truma CP plus VarioHeat control panel or the Truma App.



Truma VarioHeat

- **Light:** Weighs just 5.5 kg
- **Time-saving:** Simple and flexible installation
- **Troubleshooting capability:** Simply read out the fault memory with the Truma Diagnose Tool
- **Extendable:** The Truma E-Kit can also be added

Truma E-Kit

- **Practical:** Simple to retrofit
- **Variable:** Can be installed upright and horizontally
- **Networked:** Easy to integrate into the Truma iNet System

Variants VarioHeat

- Truma VarioHeat eco
- Truma VarioHeat comfort
- **Electric heater:** Truma E-Kit

Truma E-Kit dates

Series start August 2018

Truma CP plus VarioHeat – iNet ready*

iNet-capable appliances can be controlled and monitored with the digital control panel. The ergonomic design and intuitive operation simplify adjustment of the desired functions.

- **Intuitive operation:** With a practical rotary push button from the automotive sector
- **Large display:** With background lighting on which the symbols are also clearly readable at night
- **Power saving mode:** Lighting can be switched off in two levels if functions are not being used

Can be extended with the Truma iNet Box*

With this it is also possible to control and monitor TIN bus-capable appliances via the Truma App.

* Detailed information can be found in the Truma iNet System product info in the dealer Login at www.truma.com.

Function

Truma VarioHeat



The Truma VarioHeat is a warm air heater for air circulation to heat camping vehicles quickly in gas mode.

- **Fan-supported burner:** Ensures that operation is problem-free, even when on the move.
- **Automatic fan level selection:** According to the temperature difference between the room temperature set on the control panel and the current room temperature. This appliance always starts up at the lowest setting. If this is not sufficient to achieve the desired temperature inside the vehicle, the appliance switches to a higher operating level after about 5 minutes.
- **Circulation air mode:** can be selected with or without heating mode in various ventilation levels

Truma E-Kit



The Truma E-Kit is installed in addition to the Truma VarioHeat. Heating is possible in gas, electrical or mixed mode with this combination.

- **Electrical mode:** Only the Truma E-Kit is used for heating in the 900 or 1800 W operating levels. Warm air distribution is via the Truma VarioHeat.
- **Mixed mode:** Start in gas mode, electrical mode is activated. A total output of 4600 W is achieved in combination with the Truma VarioHeat eco, and 5500 W is achieved with the Truma VarioHeat comfort.

Truma CP plus VarioHeat digital control panel



The Truma CP plus VarioHeat control panel is used to control and monitor a Truma VarioHeat heater (with or without Truma E-Kit) and / or a Truma air conditioning system.

- **Room temperature:** Individually adjustable
- **Timer function:** Programming of the connected iNet-capable appliances, e.g. night-time reduction, automatic climate control
- **Fan levels:** Individually adjustable circulation air mode
- **Auto:** Heating power is automatically regulated
- **Night mode:** for an uninterrupted peaceful night
- **Boost:** for very quick heating
- **Additional functions with Truma E-Kit:** Electric mode and mixed mode

Truma VarioHeat installation

To achieve even heating of the vehicle, it must be ensured that the heater is installed in the vehicle as centrally as possible.

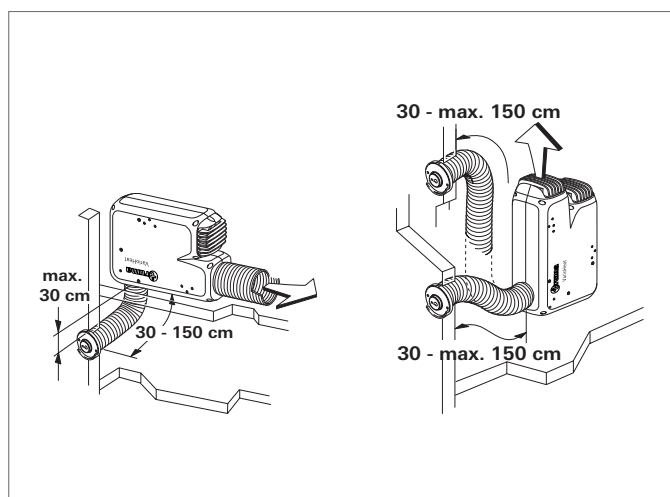

The mounting brackets enable the Truma VarioHeat to be easily installed in various installation positions.

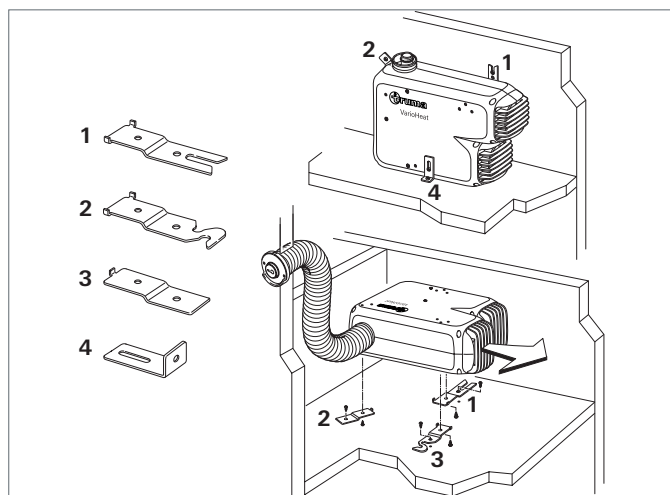

Wall cowl kits

Two wall cowl kits are available: for wall thicknesses up to 20 mm (EW 24) and up to 40 mm (64 L).

Warm air distribution

The heater routes the warm air either directly or via flexible ducts mainly in the floor of the living compartment.

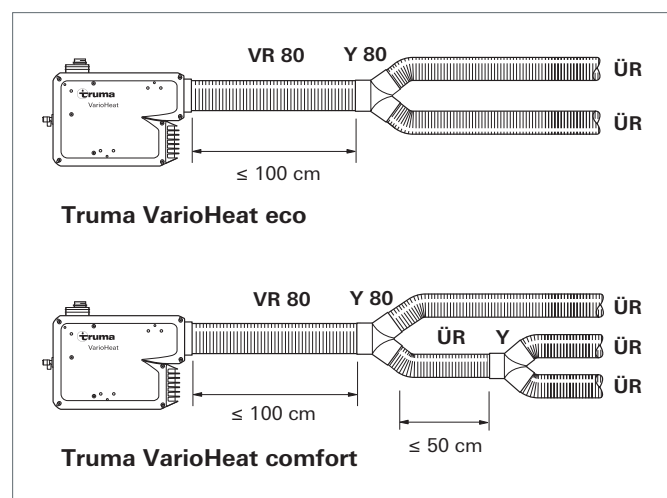

Gas connector

The 30 mbar operating pressure of the gas supply must correspond to the appliance's operating pressure (see type plate).

Power supply

The 12 V connector cable is connected to the electronics of the Truma VarioHeat.

Room temperature sensor

The provided room temperature sensor must always be connected, otherwise the heater will switch to fault.

Truma CP plus VarioHeat

Lay the connector cable (TIN bus) to the heater and if necessary to the air conditioning system, and plug in on the Truma CP plus VarioHeat control panel. Plug in the 12 V connector cable and connect to an unswitched 12 V operating voltage (permanent positive).

Attention

None of the connector cables may be longer than 10 m.

The installation instructions provided with the appliance must be observed.

Truma E-Kit installation

The Truma E-Kit can be added directly to the heater or integrated into the warm air distribution. The maximum total duct length of the VR 80 (including Truma E-Kit) is 100 cm.

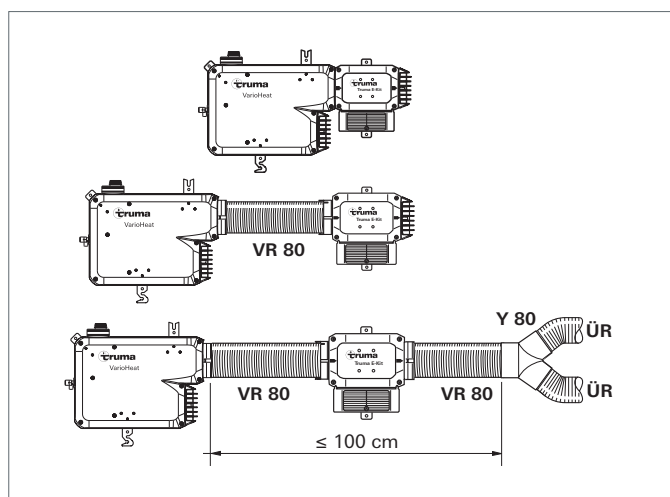

The Truma E-Kit is secured to the floor or wall with a mounting bracket (included in the scope of delivery). The duct adapter (optional) is required for installation into the Ø 80 mm warm air distribution. Only the duct VR 80* or the elbow BG 80 may be plugged into this.

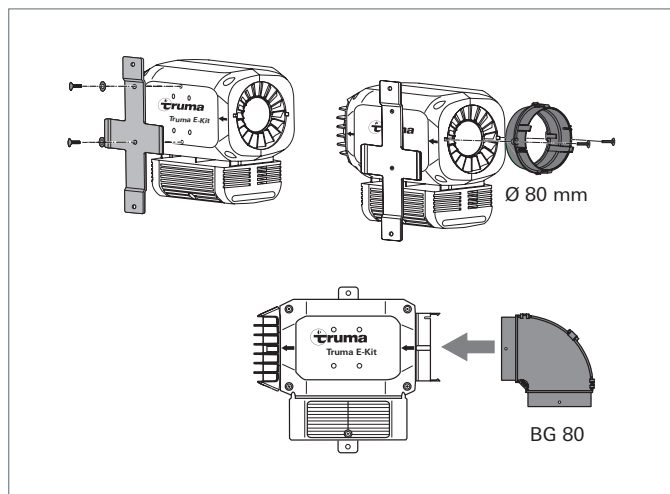

Power supply

The Truma E-Kit is connected to both the 12 V power supply and the 230 V supply.

Control unit connection

The Truma E-Kit is plugged into the TIN distributor (2) with the TIN connecting cable (1).

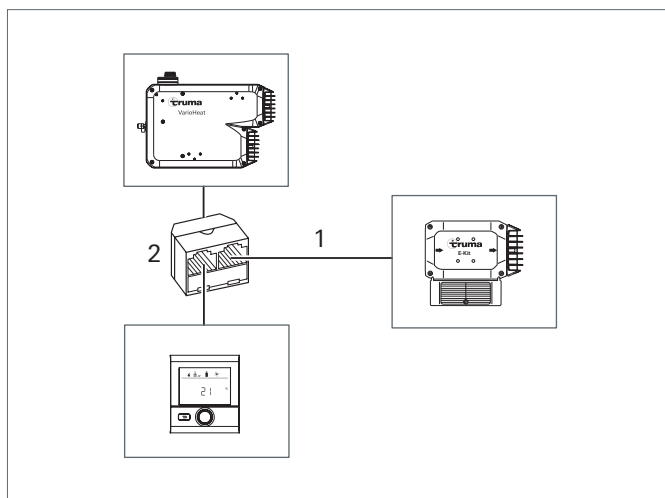

Attention

None of the connector cables may be longer than 10 m.

The installation instructions provided with the appliance must be observed.

* Part numbers can be found in the current dealership catalogue and in Truma Parts in the dealership Login at www.truma.com.

Technical data



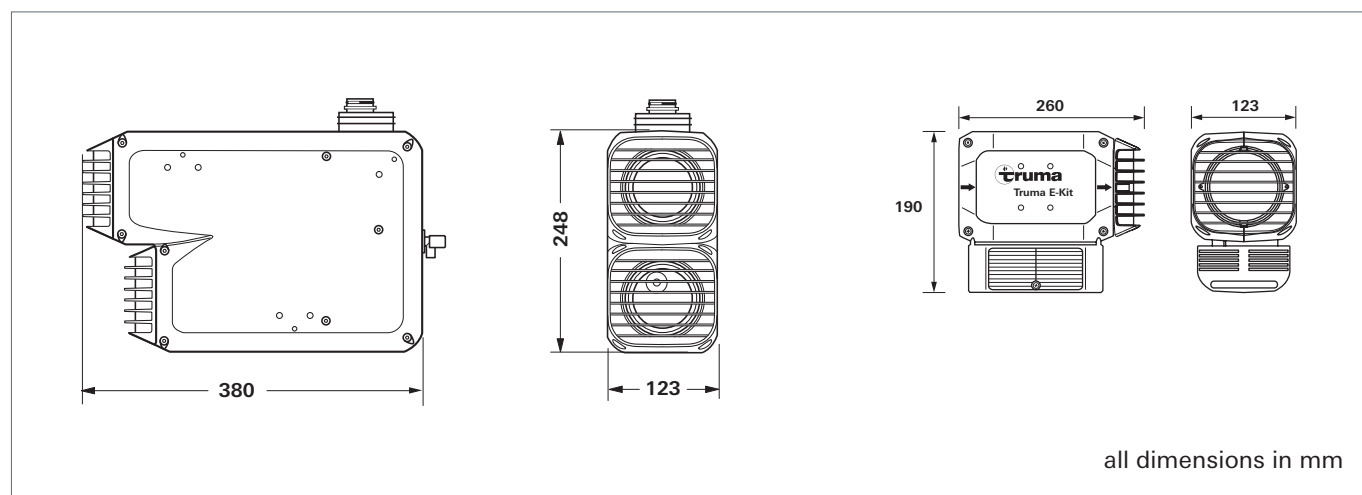

	Truma VarioHeat eco		Truma VarioHeat comfort		Truma E-Kit	
Rated thermal output	Level 1	1 300 W	Level 1	1 300 W	Level 1	900 W
	Level 2	2 800 W	Level 2	2 800 W	Level 2	1800 W
			Level 3	3 700 W		
Air delivery volume	Level 1	75 m ³ /h	Level 1	75 m ³ /h	–	
	Level 2	155 m ³ /h	Level 2	155 m ³ /h		
			Level 3	210 m ³ /h		
Gas consumption (propane/butane)	Level 1	100 g/h	Level 1	100 g/h	–	
	Level 2	220 g/h	Level 2	220 g/h		
			Level 3	290 g/h		
Power consumption (12 V)	Level 1	0.65 A	Level 1	0.65 A	approx. 0.15 A	
	Level 2	2.75 A	Level 2	2.75 A		
			Level 3	5.4 A		
Power consumption (230 V)	–		–		Level 1	3.9 A
					Level 2	7.8 A
Quiescent current, heater with Truma CP plus VarioHeat	0.004 A		0.004 A		–	
Weight					2.2 kg	
Heater without periphery	5.5 kg		5.5 kg			

The Truma E-Kit is only approved for the Truma VarioHeat. It must not be used while on the move.

Dimensions



Part numbers

Product	Part No.	Description
		Truma VarioHeat with Truma CP plus VarioHeat control panel, cable length 6 m, room temperature sensor, installation bracket and accessories for the electrical connection
	37401-01	Truma VarioHeat eco
	37501-01	Truma VarioHeat comfort
	39200-01	Truma E-Kit with mounting bracket and connection cable
	39630-01	Duct adapter
	39492-01	Elbow BG

Wall cowl kits must be ordered separately

The part numbers for the wall cowl kits and other accessories can be found in the current dealers' catalogue or in Truma Parts in the dealer Login at www.truma.com.

Truma Gerätetechnik GmbH & Co. KG
Wernher-von-Braun-Straße 12
85640 Putzbrunn
Germany
Telefon +49 (0)89 4617-2020
customer care@truma.com

The right to effect technical modifications is reserved!

www.truma.com

 **truma**
More comfort on the move